

INSTALLATION INSTRUCTIONS

DESCRIPTION: Fusion Fit Bed Attachment

PART NUMBER: J0G-F34A0-V0

MODEL: '18 ~ UMAX (all)



⚠ WARNING

Please read and understand these instructions completely before installation to avoid possible injury, or damage to the accessory or vehicle.

NOTICES:

This installation requires a torque wrench and should be performed by an authorized Yamaha dealer or other qualified technician.

WARRANTY INFORMATION:

In the United States, see your authorized Yamaha dealer for a copy of the Yamaha Genuine Parts and Accessories Limited Warranty.

DEALER OR INSTALLER:

These instructions contain important information for future reference and *must* be given to the customer.

PARTS LIST:

No.	Part Number	Description	Qty
--	J0G-F34A0-V0	Fusion Fit Bed Attachment	--
①	*	Fusion Fit	2
②	*	M6x35mm Button Head Bolt	4
③	*	M6x40mm Button Head Bolt	4
④	*	M6 Nyloc® Nut	8
⑤	*	Foam Strip	2

* Part supplied with kit only and not available separately.

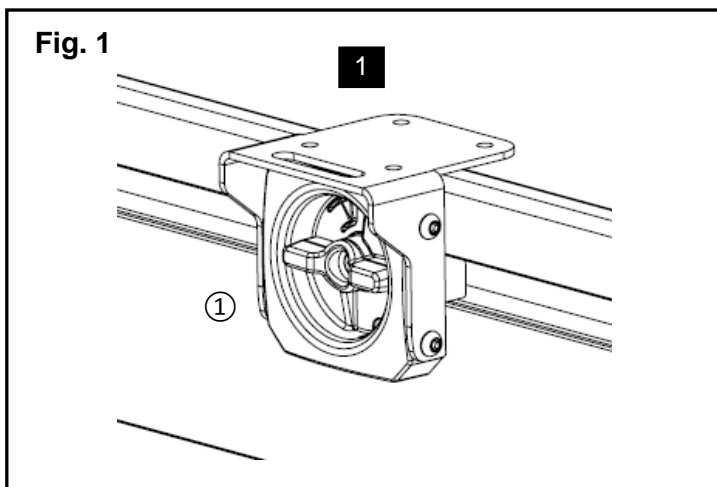
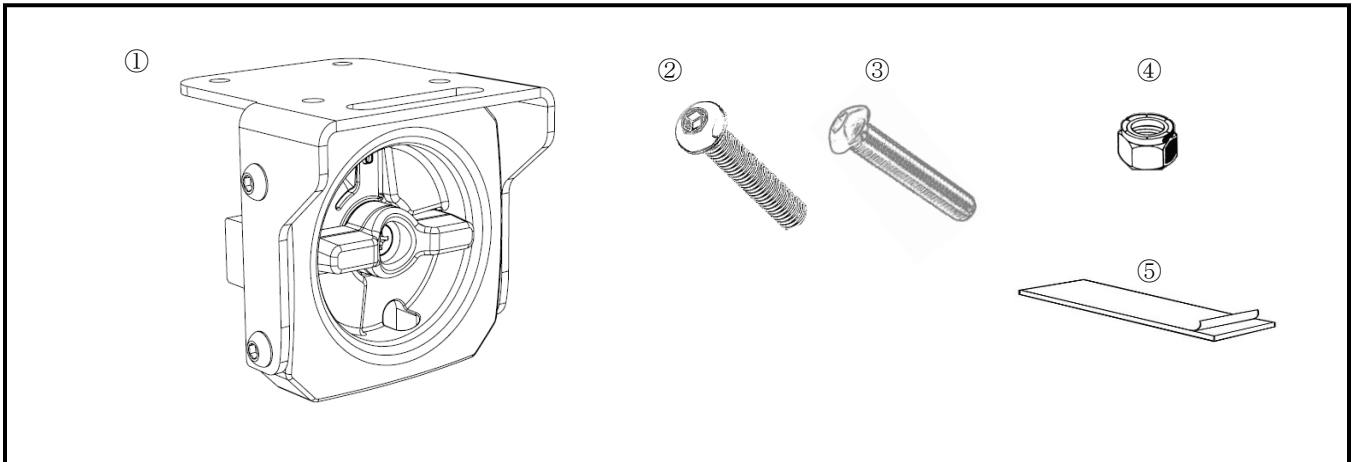

PREPARATION:

- Park the golf car on a secure and level surface.
- Clean the bed rail before beginning installation.
- Washers used in this installation are in the Yamaha 'Gripper Gun Holder' (P/N DBY-ACC56-00-83)

INSTALLATION:

- 1 Ensure knob is in the "unlocked" position. Install onto bed rail in order to mark foam tape location.

Fig. 2

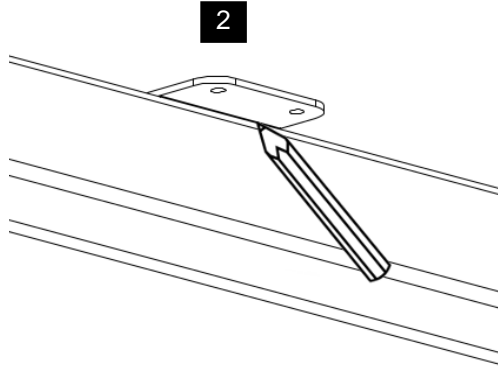

2 On outside of bed side, mark metal bracket with pencil along top edge of bed. This will serve as a guide to install the foam tape.

3 Remove paper backing from tape and press to install. See Fig. 3.

4 Adjust the tension on the lock. Use a Phillips Head screw driver and turn the center screw clockwise until it bottoms out. Then, turn the screw $\frac{1}{2}$ turn to set the tension of the Lock/Unlock knob. See Fig. 4

How to Install

Install the Fusion Fit to the top channel in the Frame Rail of the cargo bed. The Knob has to be in the unlocked position. Simply press the bar into the Rail. Turn the handle clockwise to lock.

How to Unlock and Remove

Press in on the 'lock tab' and turn the knob counter clockwise to put the knob in the unlock position. Pull the Fusion Fit from the frame rail.

Fig. 3

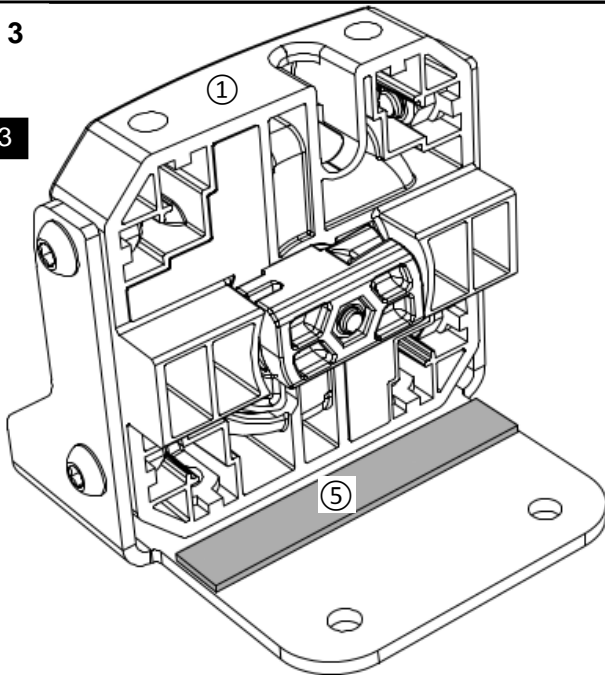

Fig. 4

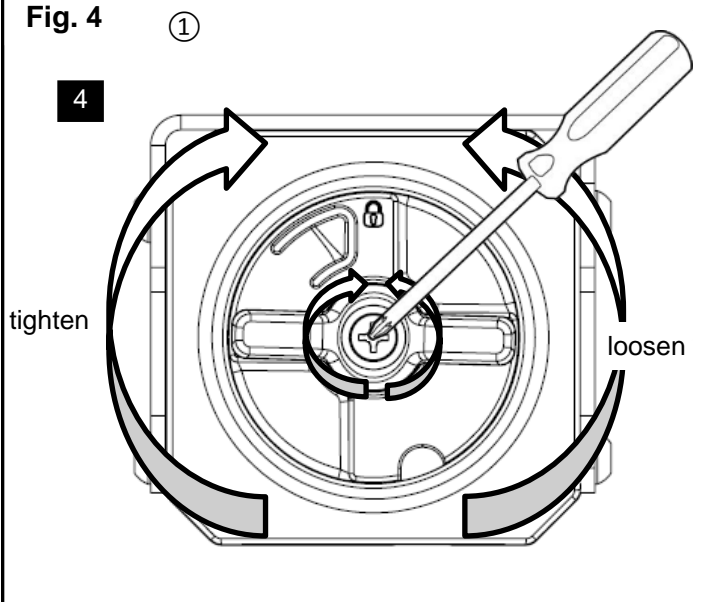
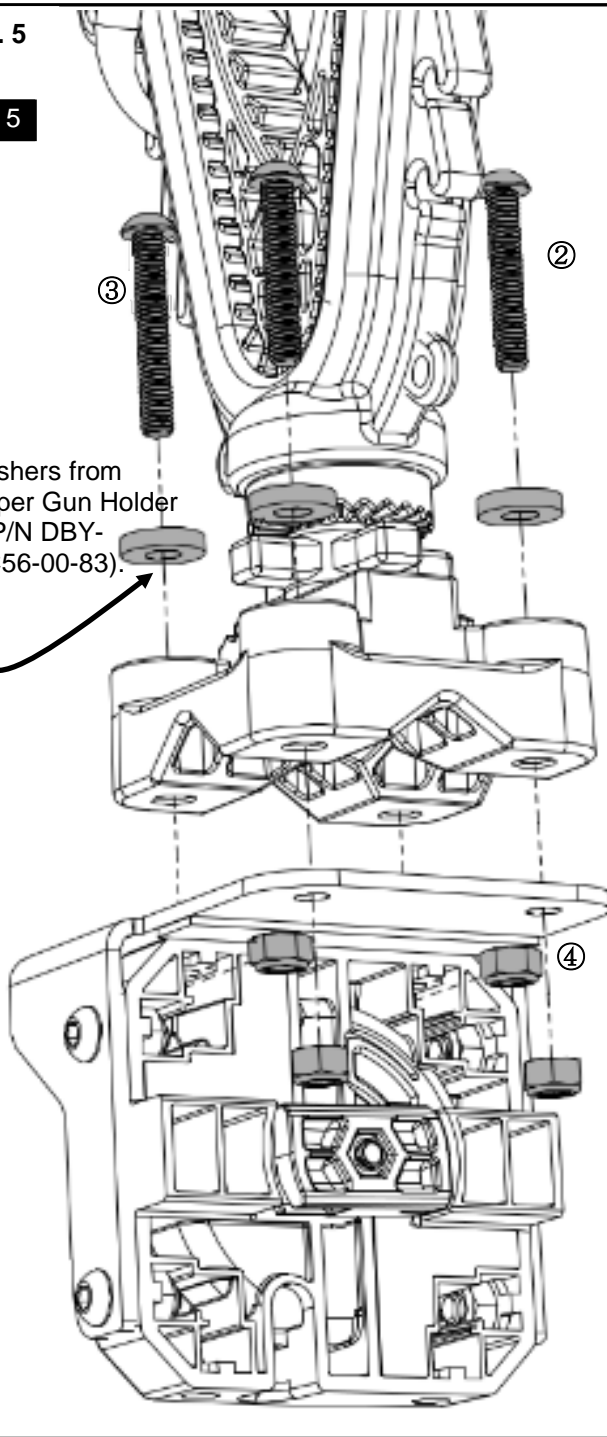

Fig. 5

5

*Washers from Gripper Gun Holder kit (P/N DBY-ACC56-00-83).



V-Grip Mount Installation

5 Use the four washers from the Gripper Gun Holder kit and the included hardware (four ④ M6 Nyloc® nuts, two ② M6x35, and two ③ M6x40) to attach accessory grip mounts to the ① Fusion Fit mount. Torque to 1.5Nm. See Fig. 5.

Note: Part shown is the Yamaha 'Gripper Gun Holder' (P/N DBY-ACC56-00-83). Check with your dealer for additional accessories.

MAINTENANCE:

Periodically, check torque on all hardware. If loose hardware is found, re-torque to specification.

CARE AND CLEANING:

Clean painted metal parts and plastics with a clean soft cloth and mild soap and water. Rinse and dry.

CUSTOMER SERVICE:

For further information see your Yamaha dealer.

ESTIMATED TIME TO INSTALL: 0.3 HRS